

POP-UP OPEN HOUSE

SAT, MAR 1 | Noon-2pm

BAYSHORE
HOME SALES
888.855.1818
www.BayshoreHomeSales.com

Colonial East
Manufactured Home Community
Home For Sale

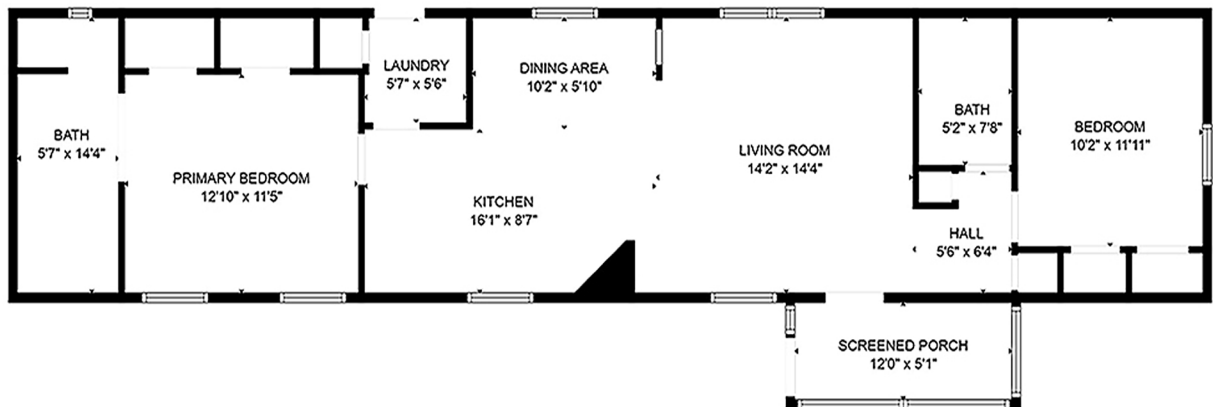
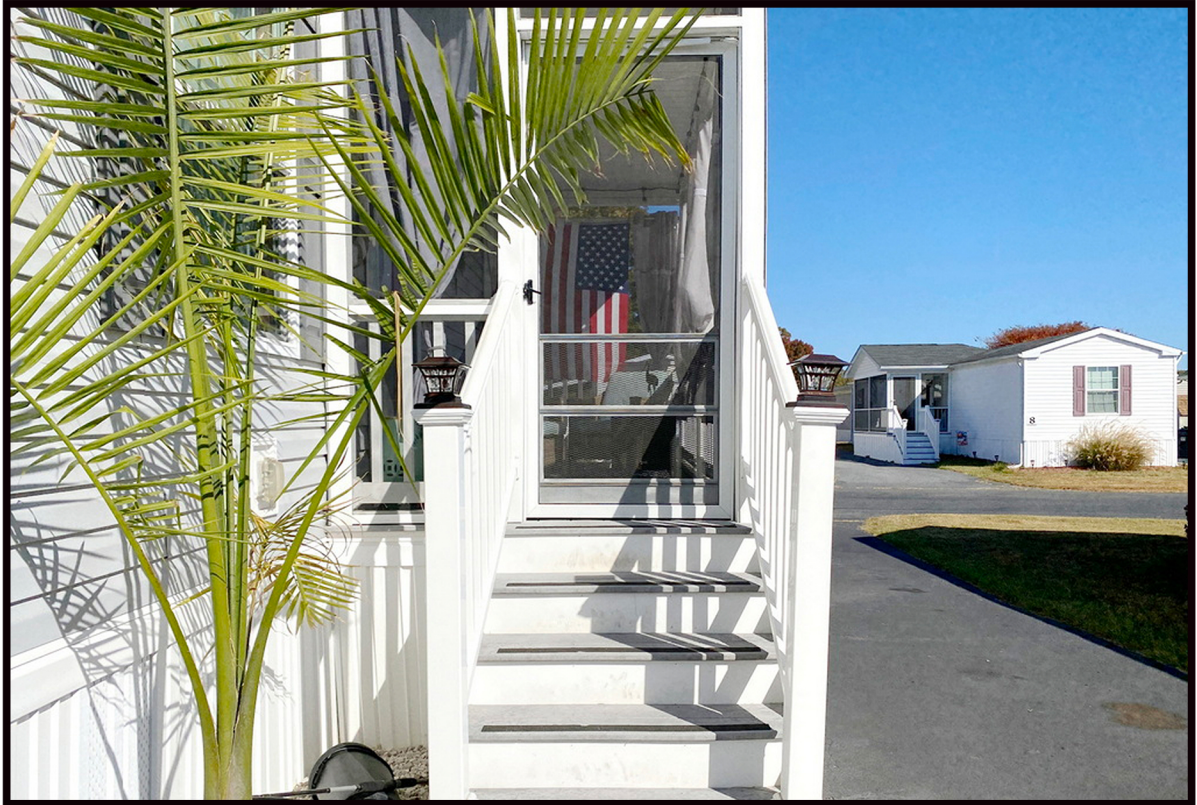

7 Spinning Wheel Lane

Being sold beautifully-furnished, this 2BR\2BA home six miles from the Boardwalk is for sale! Located East of Route 1, mid-way between Lewes and Rehoboth Beach, this home combines coastal style and comfortable living. Pull into the driveway, and the curb appeal is apparent from the pink flamingo touches, lush landscaping and color coordinated shed for your tools and beach gear. The screened porch is perfect for entertaining al fresco. It leads the way inside where you'll find a split floor plan, plenty of open space, with built-ins and designer touches throughout. An electric fireplace helps to make an inviting environment for your family and friends. The eat-in galley kitchen is an efficiently organized for meal prep and features plenty of cabinet space to house all of the cook's tools. The primary bedroom situated at the back of the home features an ensuite bath, a spa-like, relaxing space to wind down from your day. This thoughtful floor plan also includes a guest bedroom, another full bath and functional laundry and mudroom.

Colonial East's amenities include a refreshing outdoor pool, spotless community center, playground, dog park and grilling area. Seasonal grass cutting, recycling and snow removal are included. Got an RV or boat? Park it in our storage yard for an additional fee. As a resident of Colonial East you will enjoy community events, onsite management, and live life in a neighborhood close to world-class restaurants, tax-free shopping in our many fine independent shops, outlets and businesses. Find your fun at Midway Speed Park, at the Movies at Midway or hop on the beach shuttle and head to the Rehoboth Beach Boardwalk. Don't miss this opportunity to live life and live it here at the beach.

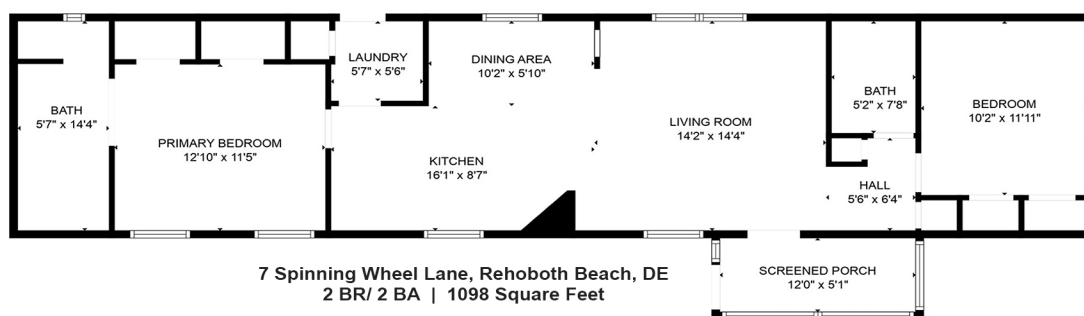

FLOOR PLAN CREATED BY CUBICASA APP. MEASUREMENTS DEEMED HIGHLY RELIABLE BUT NOT GUARANTEED.

APPROX SIZE: 1098 Sq FT

ROOMS: Living Room, Primary Bedroom, Bedroom 2, Kitchen, Foyer

INTERIOR FEATURES: Breakfast Area, Built-Ins, Carpet, Ceiling Fans, Kitchen/Living Combo, Dining Area, Entry Level Bedrooms, Open Floor Plan, Primary Bath, 2nd Bathroom w/Tub, Shower

FIREPLACE: One, Electric

APPLIANCES: Dishwasher, Gas Oven/Range, Refrigerator w/Ice and Water Dispenser Washer, Dryer, Water Heater

FLOORING: Vinyl, Luxury Vinyl Plank, Carpet

BATHROOMS: 2

BEDROOMS: Primary Bedroom: Carpet, Ensuite Bath with Built-ins, Ceiling Fan

Bedroom 2: Carpet, Ceiling Fan

OTHER ROOMS:

Foyer/Entry: Vinyl Flooring

Living Room: Laminate Plank Flooring, Ceiling Fan

Kitchen: Crown Molding, Breakfast Nook, Double Sink, Gas Cooking, Vinyl Flooring

Laundry/Mud Room: Vinyl Flooring

Porch: Screened, Enclosed, Roof

PARKING: 2 Cars, Off Street

HEATING & COOLING:

Central Air: Electric with Ceiling Fan(s)

Heating Type: Heat Pump(s), Propane - Metered

Water Heater: Electric, 60+ Gallon Tank

LAND LEASE: \$965 per month